

Xenon Beacons MXB124SB and MXB124DB



MXB124DB weatherproof xenon beacon



MXB124SB low profile xenon beacon



low profile base



weatherproof base

Overview

This range of Menvier xenon beacons is available to complement purely audible alarms for use in areas either where people may be present who have impaired hearing or areas with high ambient noise levels.

Xenon beacons have a high light output to maximise the attention attracting potential of the device.

MXB124SB

The MXB124SB low profile xenon beacon features a high performance light source. Pre-drilled fixing and cable entry holes it is simple to install.

MXB124DB

The MXB124DB weatherproof xenon beacon is IP65 rated and supports side entry surface cables making it ideal for industrial applications.

Lower power LED variants are also available which offer a lower current consumption but have a consequently lower light output than traditional xenon types (MLB124SB and MLB124DB LED beacons).

Features

MXB124SB

- Unobtrusive low profile design
- High output xenon beacon
- Pre drilled cable entries entry holes

MXB124DB

- Weatherproof version (IP65)
- High output xenon beacon
- Choice of cable entry positions

Benefits

- first fix base
- Compatible with range of Menvier fire detection panels
- Weatherproof version

Conventional Xenon Beacons - MXB124SB and MXB124DB

Dimensions

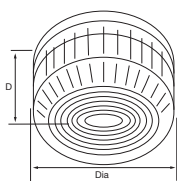

Low profile
xenon beacon

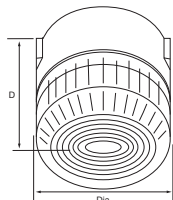

Weatherproof
xenon beacon

Description	Dia (mm)	D (mm)
Low profile xenon beacon	93	72
Weatherproof xenon beacon	93	101

Technical Specification

Code	MXB124SB	MXB124DB
Description	Low profile xenon beacon	Weatherproof xenon beacon
Specification		
Operating Voltage	24V dc	24V dc
Current Consumption	45mA at 24V dc	45mA at 24V dc
Operation	Continuous	Continuous
Flash Energy	1.45J	1.45J
Flash Frequency	60 per minute	60 per minute
Environmental		
Operating Temperature	-20°C to +55°C	-20°C to +55°C
Humidity (Non Condensing)	0 to 93% RH	0 to 93 RH
Physical		
Construction	PC/ABS	PC/ABS
Colour	Red	Red
Lens Colour	Red	Red
Dimensions (Dia x D)	93mm x 72mm	93mm x 101mm
Weight	0.2kg	0.25kg
Ingress Protection	IP54	IP65
Cable Entry	Rear	Rear/side
Compatibility		
Suitable for use with	Menvier conventional fire systems	Menvier conventional fire systems

Standard Connection

MXB124SB / MXB124DB

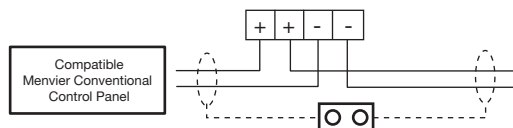

WARNING:

Do NOT use high voltage testers if ANY equipment is connected to the system.

Screen (Earth) must be continuous along entire length of cable

Installation

MXB124SB

1. Supplied with simple to install first fix mounting base.
2. Fixing and cable entry holes are pre-drilled.
3. Cable entry is from rear.
4. Connections are to main beacon body.
5. Separate alarm line in / out terminals are provided.
6. Main body is pushed into sounder base and then twisted to lock into place.

MXB124DB

1. Supplied with simple to install first fix mounting base.
2. Cable entry is from rear or side.
3. Connections are to main beacon body.
4. Separate alarm line in / out terminals are provided.
5. Main body is pushed into sounder base and then twisted to lock into place.

Interface Options

MXB124SB / MXB124DB

1. Operates from nominal 24V dc supply and can be connected to any suitably rated conventional sounder circuit.

Product Codes

Code	Description
MXB124SB	Conventional low profile xenon beacon, 1 Watt
MXB124DB	Conventional weatherproof xenon beacon, 1 Watt
MXB224SB	Conventional low profile xenon beacon, 2 Watt
MXB224DB	Conventional weatherproof xenon beacon, 2 Watt